

©2015



Listing Courtesy of:  RMLS / Windermere  
Real Estate/Lane County / Shawn Hittenberger



**Shawn Hittenberger**  
Windermere Real Estate/Lane  
County

Office: (541) 484-2022  
Mobile: (541) 228-7090

[shawnandkaren@windermere.com](mailto:shawnandkaren@windermere.com)  
<http://shawnandkaren.com>

Cottage Grove Area Land

**1510 Elm Ave 58**  
**Cottage Grove OR 97424**

Active  
**\$69,900**

---

Cumulative Days on Market: 1141

MLS #: **15044269**

Taxes: **\$846**

Lot Size: **7,841 SQFT**

Type: **Land**

Year Built:

Style:

Views: **Trees, Mountain, Valley**

School  
District:

County: **Lane Co.**

Community:

## 1510 Elm Ave 58 Cottage Grove , OR 97424

MLS #: **15044269** | Active \$69,900

### Comments

Building lots for sale in Sunrise Ridge Subdivision. Sunrise Building lots for sale in Sunrise Estates Subdivision. Sunrise Estates is a planned development that rises gently from established city neighborhoods to offer commanding views to the East and South over the city of Cottage Grove. There are lots available in different locations and price points to fit every budget! Bring your own builder or meet with one of our recommended buil

---

### School Information

- Elementary School: Bohemia
- Middle School: Lincoln
- High School: Cottage Grove

### Subdivision

- Sunrise Estates

## 1510 Elm Ave 58 Cottage Grove , OR 97424

MLS #: **15044269** | Active \$69,900

### Listing Price History

 Walk Score® **19**

Date	Event	Price	% Change	\$ (+/-)
Jan 18, 2018	Price Changed	\$69,900	8%	4,900

Disclaimer: All information provided is deemed reliable but is not guaranteed and should be independently verified. Listing data comes in part from the RMLS of Portland, Oregon and is copyright 2018 RMLS. Real Estate listings held by brokerage firms other than Windermere are explicitly identified. Some properties which appear for sale may have subsequently been sold or may no longer be available: The content last updated on 5/22/18 04:06. Listing Data Copyright 2018 RMLS. All rights reserved. 

# Cottage Grove Area Land

**1510 Elm Ave 58**  
**Cottage Grove OR 97424**

Active  
**\$69,900**  
View on map  
Drive Times



© 2015

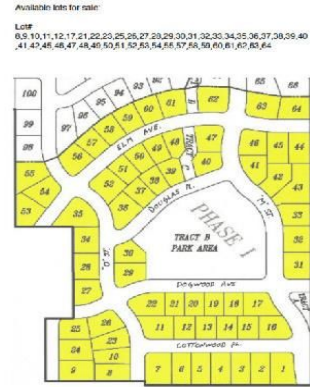

© 2015



© 2015



**1510 Elm Ave 58 Cottage Grove , OR 97424**

MLS #: **15044269** | Active \$69,900

